

MEMORIAL ASHES GARDENS DETAILS

GRAVE LOCATION FOLDER
PAGE 14

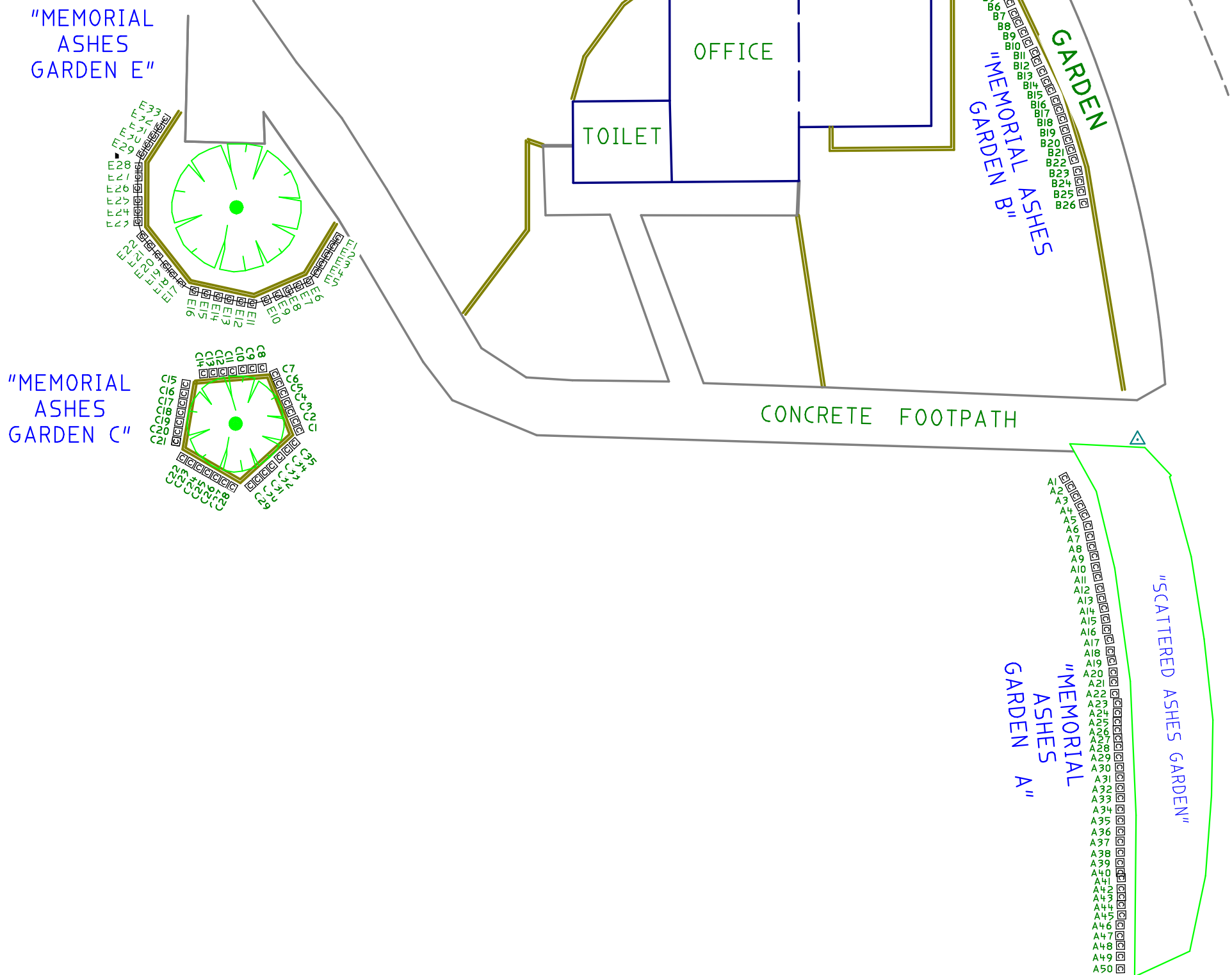

**THOMAS &
GEORGE**

LICENSED SURVEYORS

Lilydale:

Phone: 03 9735-1338

4/4 Clarke Street, Lilydale 3140.

P.O. Box 366, Lilydale, 3140

REF: 200055 / GLFP14

LAST AMENDMENT: 15/10/15

VERSION: 02

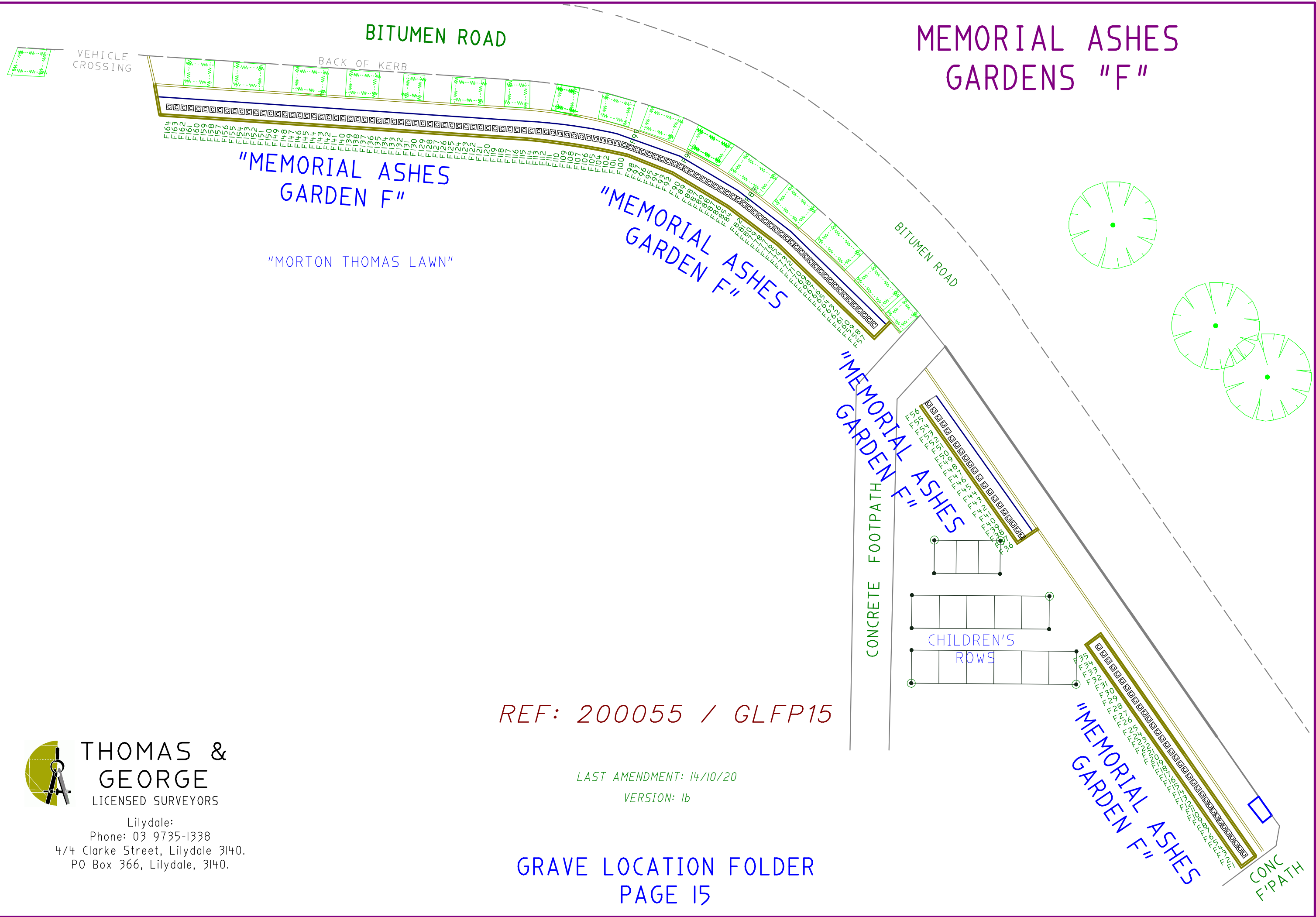

MEMORIAL ASHES
GARDENS "F"

"MEMORIAL ASHES
GARDEN F"

"MORTON THOMAS LAWN"

"MEMORIAL ASHES
GARDEN F"

"MEMORIAL ASHES
GARDEN F"

"MEMORIAL ASHES
GARDEN F"

CONCRETE FOOTPATH

CHILDREN'S
ROWS

REF: 200055 / GLFP15

LAST AMENDMENT: 14/10/20
VERSION: 1b

GRAVE LOCATION FOLDER
PAGE 15

**THOMAS &
GEORGE**
LICENSED SURVEYORS

Lilydale:
Phone: 03 9735-1338
4/4 Clarke Street, Lilydale 3140.
PO Box 366, Lilydale, 3140.